

- 1 WALL SURFACE AND PIPE SHALL BE CLEANED AND PRIMED.
- 2 APPLY SLATED UV FLEXOWALL MEMBRANE TO WALL.
- 3 FLEXOBIT COLLAR TO HAVE HOLE CUT TO DIAMETER SMALLER THAN PIPE TO ALLOW FOR SNUG FIT WHEN INSTALLED OVER PIPE.
- 4 TORCH WELD FLEXOBIT COLLAR TO SLATED UV FLEXOWALL SURFACE.
- 5 FLEXOBIT END POINTS SURROUNDING PIPE ARE TO BE COATED WITH TORCH MELTED FLEXOBIT.
- 6 PIPES EXPOSED TO UV TO HAVE SLATED UV FLEXOWALL MEMBRANE FLASHING COLLAR INSTALLED OVER FLEXOBIT COLLAR.

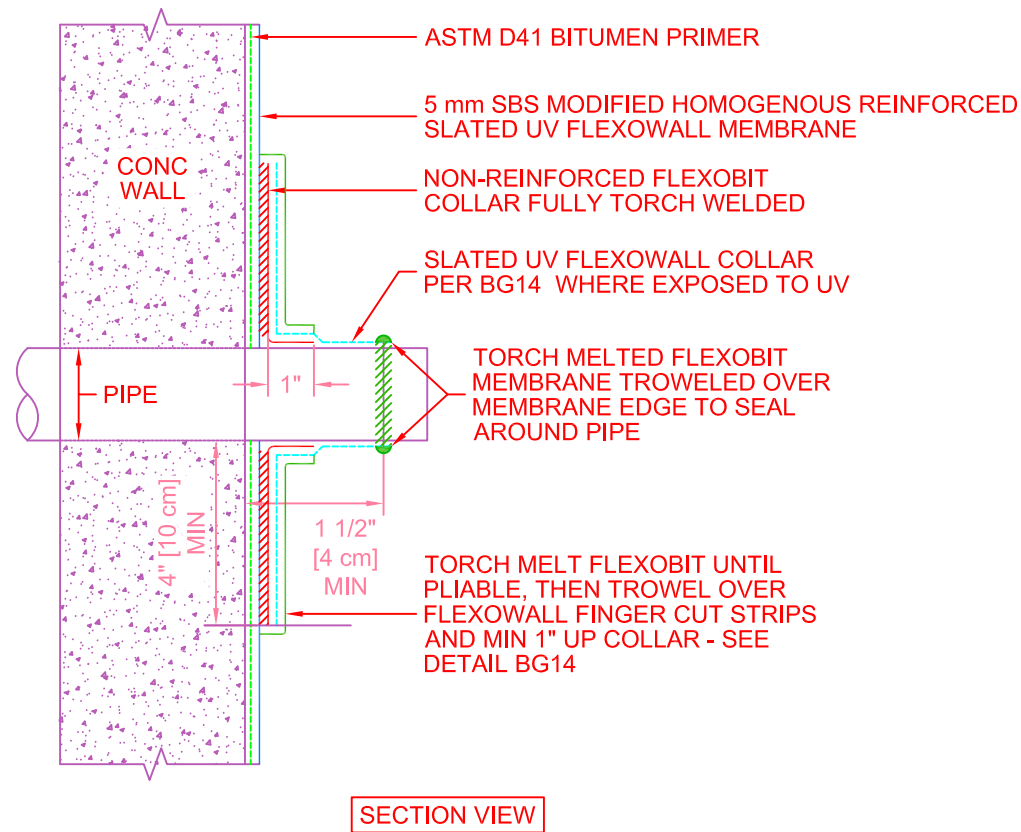

PIPE PENETRATION AT WALL  
(WITH UV EXPOSURE)